



**FEATURES:**

- Anti-Static Devices For Ball- Stem- Body
- Blow-out Proof Stem
- Pressure Balance Hole In Ball Slot
- Built In ISO 5211 Direct Mounting Pad For Easy Automation

**STANDARDS:**

- Design: DIN 3357 EN 12516-1
- Wall Thickness: ASME B16.34 EN 12516-1
- Fire Safe: API 607 ISO 10497
- Face to Face: DIN 3202
- End Flange: DIN EN 1092-1
- Inspection & Testing: DIN 3230 EN 12266

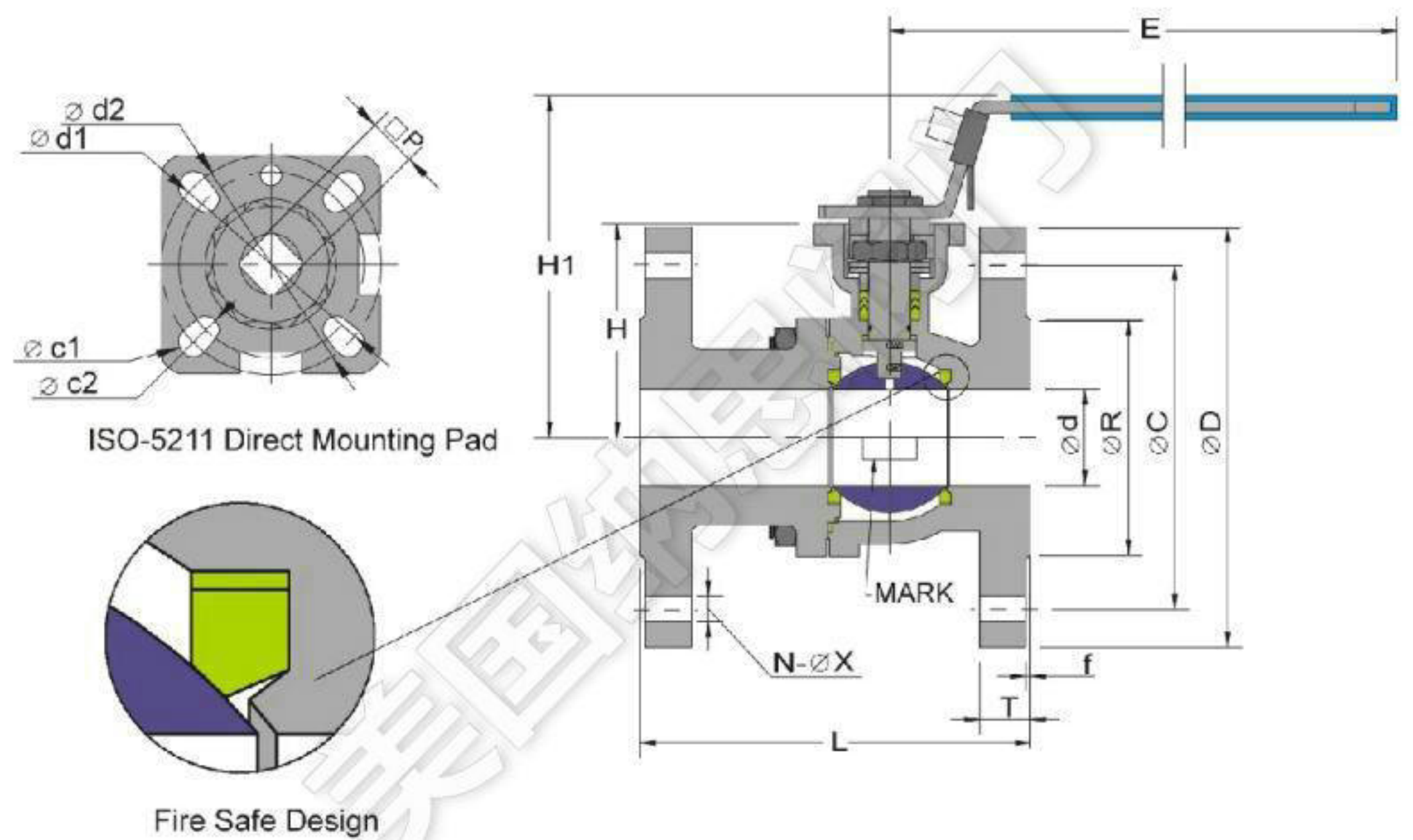

Unit:mm ■ DIN PN16-40

Size	Pressure	L	Ød	ØR	ØC	ØD	H	H1	E	T	f	N	ØX	Ød1	Ød2	ØC1	ØC2	□P	ISO-5211
1/2"	PN16-40	115	15	45	65	95	48.5	76	110	14	2	4	14	42	36	6	6	9	F03/F04
3/4"	PN16-40	120	20	58	75	105	53.5	81	110	16	2	4	14	42	36	6	6	9	F03/F04
1"	PN16-40	125	25	68	85	115	59	90	130	16	2	4	14	50	42	7	6	11	F04/F05
1-1/4"	PN16-40	130	32	78	100	140	71	102	160	16	2	4	18	50	42	7	6	11	F04/F05
1-1/2"	PN16-40	140	38	88	110	150	77.5	114.5	185	16	3	4	18	70	50	9	7	14	F05/F07
2"	PN16-40	150	50	102	125	165	85	122	185	18	3	4	18	70	50	9	7	14	F05/F07
2-1/2"	PN16	170	65	122	145	185	100	168	305	18	3	4	18	102	70	11	9	17	F07/F10
3"	PN16	180	78	138	160	200	110	178	305	20	3	8	18	102	70	11	9	17	F07/F10
4"	PN16	190	100	158	180	220	130	198	305	20	3	8	18	102	70	11	9	19	F07/F10
5"	PN16	325	125	188	210	250	165	234	500	22	3	8	18	125	102	14	12	22	F12/F14



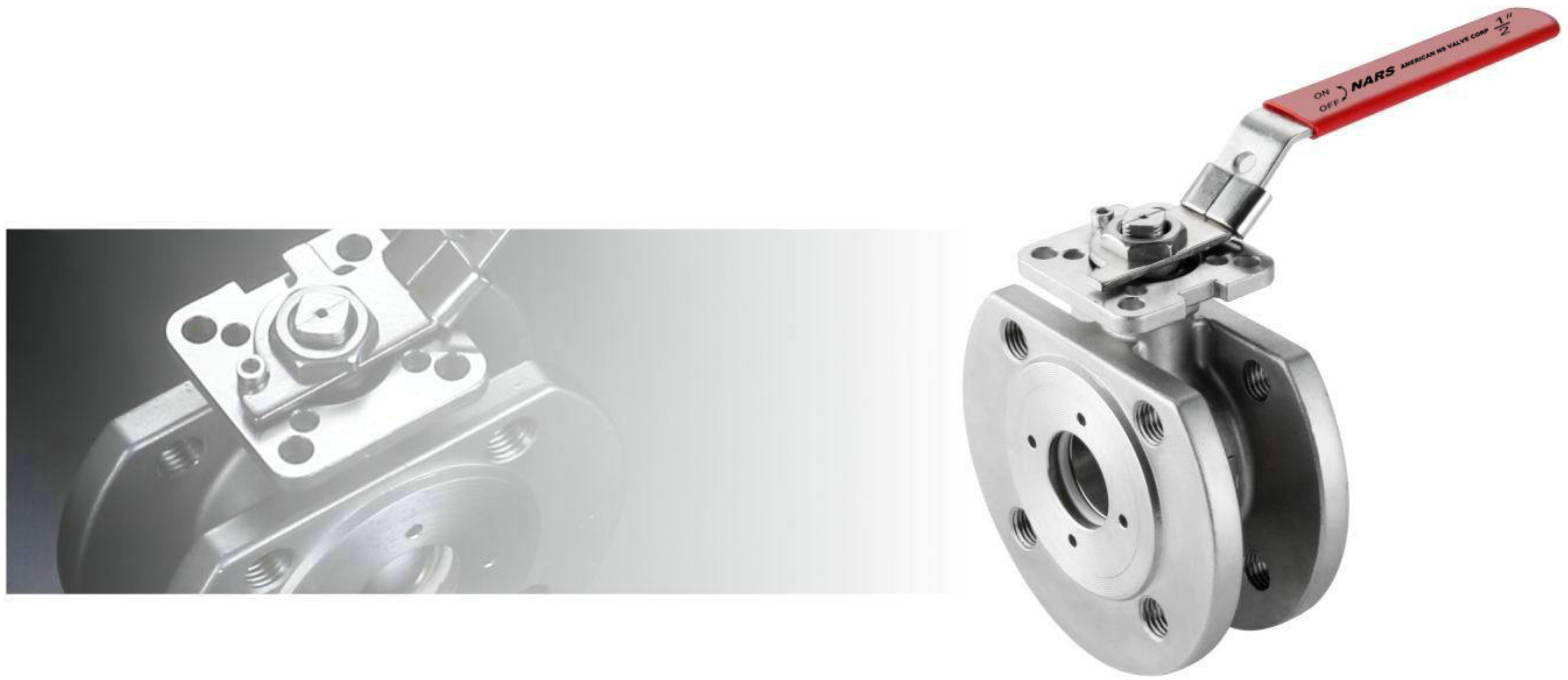

### FEATURES:

- Anti-Static Devices For Ball- Stem- Body
- Blow-out Proof Stem
- Pressure Balance Hole in Ball Slot
- Built in ISO 5211 Direct Mounting Pad for Easy Automation

### STANDARDS:

- Design: DIN 3357 EN 12516-1
- Wall Thickness: ASME B16.34 EN 12516-1
- Fire Safe: API 607 ISO 10497
- End Flange: DIN EN 1092-1
- Inspection & Testing: DIN 3230 EN 12266

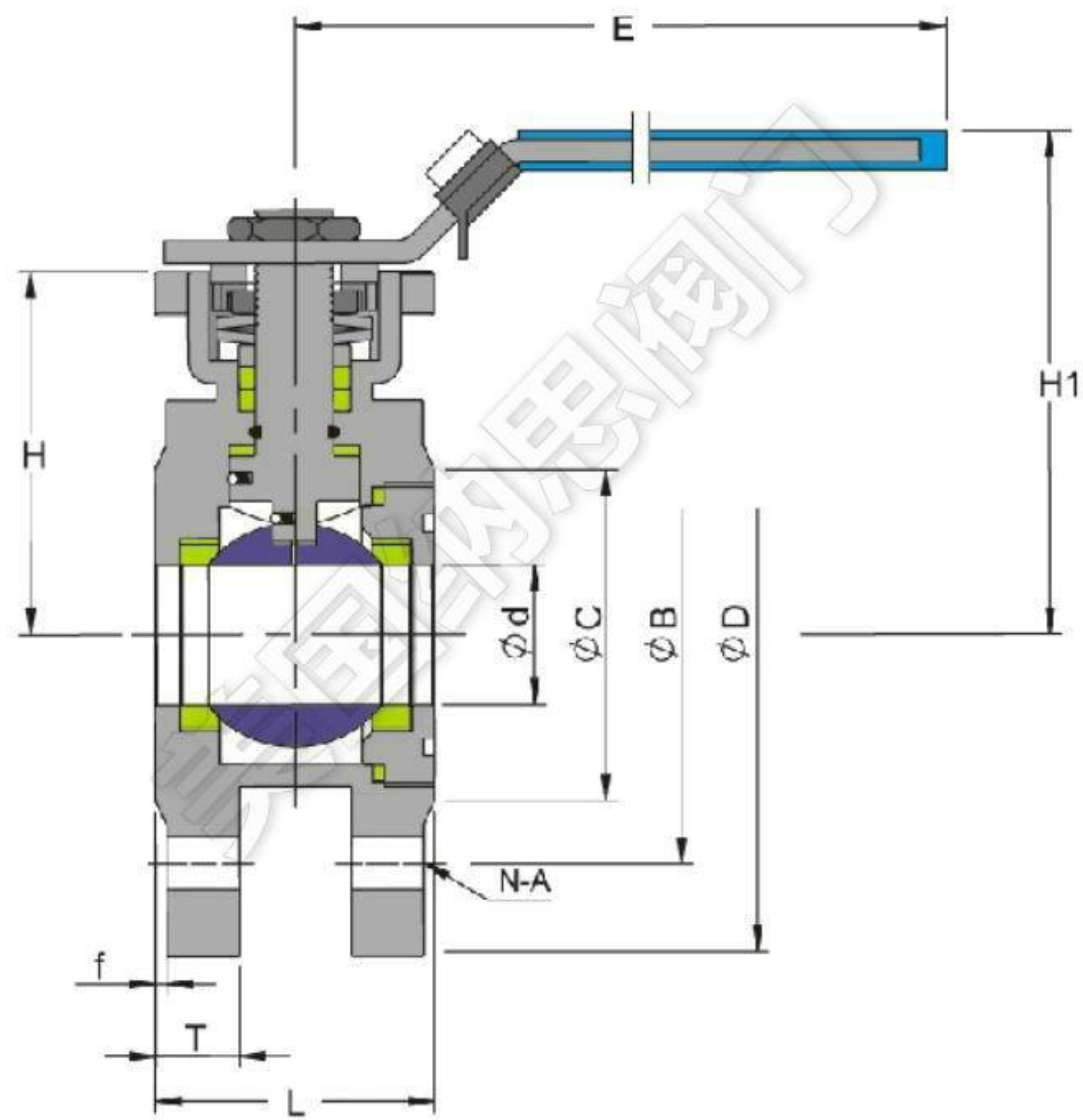
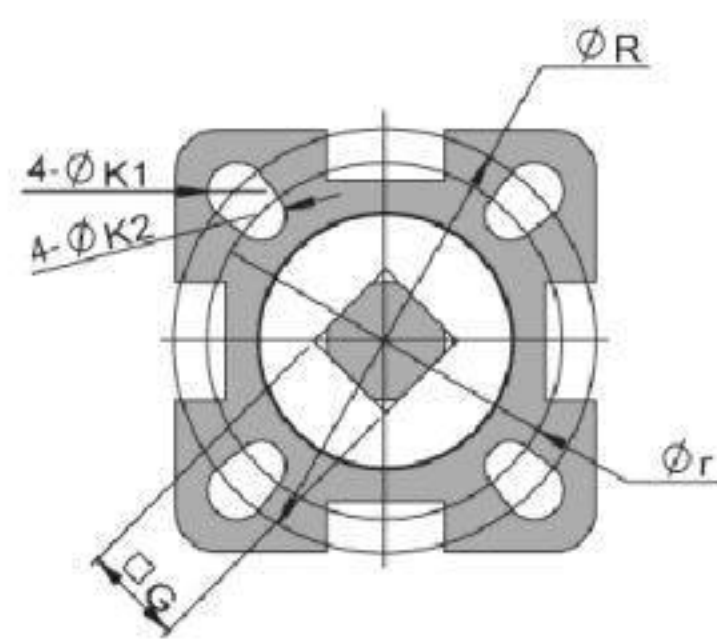

Unit:mm ■ DIN PN16/40

Size	PN	Ød	L	ØC	ØB	ØD	H	H1	E	f	T	□G	ØR	Ør	ØK1	ØK2	N	A	ISO-5211
DN15	10-40	15	42	45	65	95	48.5	76	110	2	14	9	42	36	6	6	4	M12	F03-F04
DN20	10-40	20	44	58	75	105	53.5	81	110	2	16	9	42	36	6	6	4	M12	F03-F04
DN25	10-40	25	50	68	85	115	59	90	160	2	16	11	50	42	7	6	4	M12	F04-F05
DN32	10-40	30	60	78	100	140	71	102	160	2	16	11	50	42	7	6	4	M16	F04-F05
DN40	10-40	36	65	88	110	150	78	115	185	3	16	14	70	50	9	7	4	M16	F05-F07
DN50	10-40	46	80	102	125	165	85	122	185	3	18	14	70	50	9	7	4	M16	F05-F07
DN65	10/16	57	110	122	145	185	100	168	305	3	18	17	102	70	11	9	4	M16	F07-F10
DN80	10/16	73	120	138	160	200	110	178	305	3	20	17	102	70	11	9	8	M16	F07-F10
DN100	10/16	90	150	158	180	220	130	198	305	3	20	19	102	70	11	9	8	M16	F07-F10





**FEATURES:**

- Anti-Static Devices For Ball- Stem- Body
- Blow-out Proof Stem
- Pressure Balance Hole In Ball Slot
- Built In ISO 5211 Direct Mounting Pad For Easy Automation

**STANDARDS:**

- Design: ASME B16.34
- Wall Thickness: ASME B16.34
- Fire Safe: API 607 ISO 10497
- Face to Face: ASME B 16.10
- End Flange: ASME B16.5
- Inspection & Testing: API 598

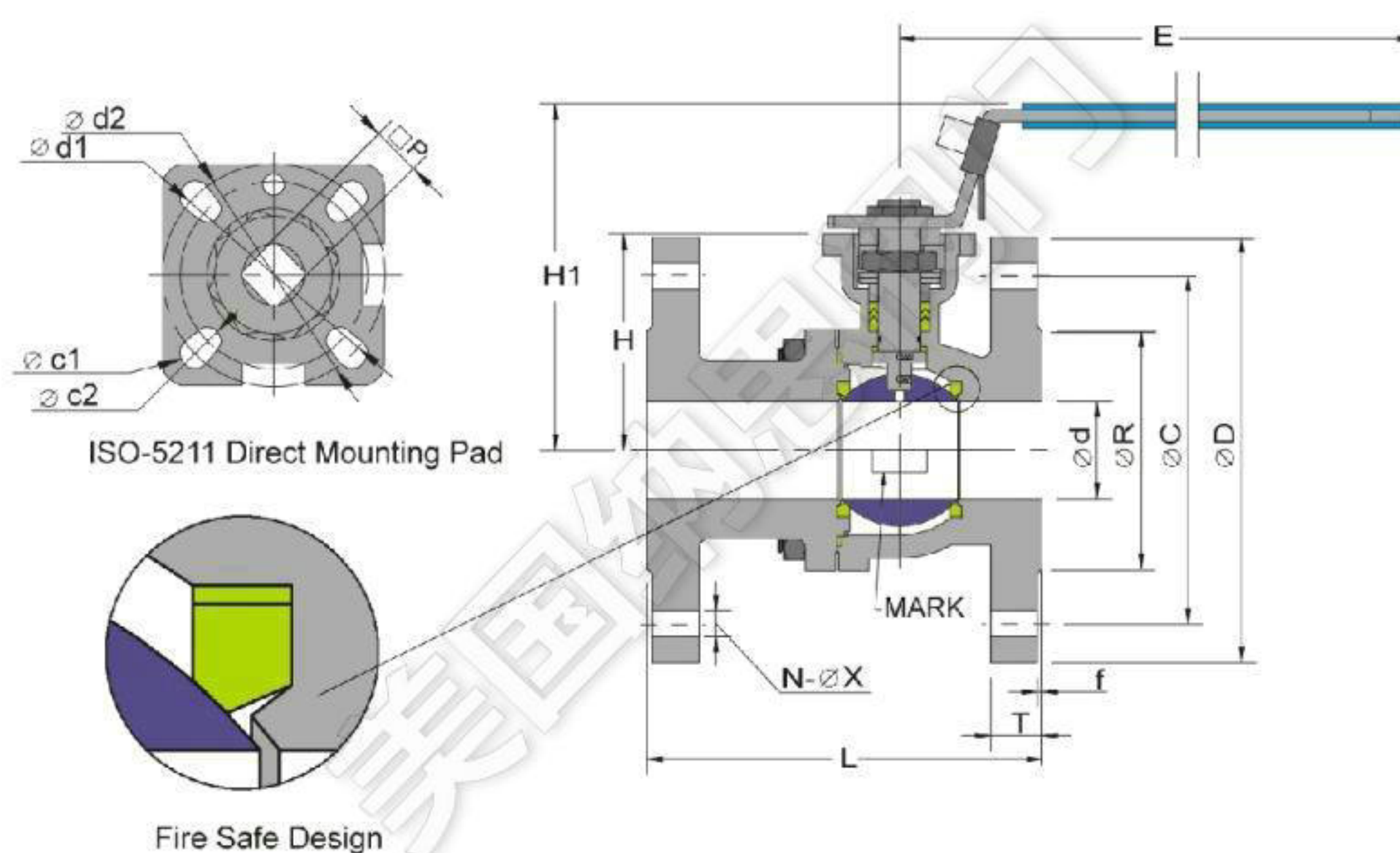

Unit:mm ■ ASME 150LBS

Size	(LBS)	L	Ød	ØR	ØC	ØD	H	H1	E	T	f	N	ØX	Ød1	Ød2	ØC1	ØC2	□P	ISO-5211
1/2"	150	108	15	34.9	60.3	90	48.5	76	110	11.2	2	4	16	42	36	6	6	9	F03/F04
3/4"	150	117	20	42.9	69.9	100	53.5	81	110	11.2	2	4	16	42	36	6	6	9	F03/F04
1"	150	127	25	50.8	79.4	110	59	90	130	12	2	4	16	50	42	7	6	11	F04/F05
1-1/4"	150	140	32	63.5	88.9	115	71	102	160	12.7	2	4	16	50	42	7	6	11	F04/F05
1-1/2"	150	165	38	73	98.4	125	77.5	114.5	185	14.3	2	4	16	70	50	9	7	14	F05/F07
2"	150	178	50	92.1	120.7	150	85	122	185	15.9	2	4	19	70	50	9	7	14	F05/F07
2-1/2"	150	190	65	104.8	139.7	180	100	168	305	17.5	2	4	19	102	70	11	9	17	F07/F10
3"	150	203	78	127	152.4	190	110	178	305	19.1	2	4	19	102	70	11	9	17	F07/F10
4"	150	229	100	157.2	190.5	230	130	198	305	23.9	2	8	19	102	70	11	9	19	F07/F10
5"	150	356	125	185.7	215.9	255	165	234	500	23.9	2	8	22	125	102	14	12	22	F12/F14



# NARSF106

3PC内螺纹经济型球阀  
3PC Ball Valve Light Type 1000WOG

Threaded Ball Valves

## 产品特点 / FEATURES:

阀杆带有防脱出装置设计 Blow-out Proof Stem  
 钢球球槽上有泄压孔设计 Pressure Balance Hole In Ball Slot  
 可选择挂锁装置 Lock Device  
 采用脱蜡精密铸造 Using Dewaxing Precision Casting

## 标准 / STANDARDS:

设计标准 / Design: ASME B16.34  
 壁厚标准 / Wall Thickness: ASME B16.34  
 螺纹标准 / Pipe Thread: ASME B1.20.1, BS21  
 DIN 2999/259, ISO 228/1 JIS B 0203, ISO 7/1  
 对焊标准 / Butt Weld: ASME B16.25  
 承插焊标准 / Socket Weld: ASME B16.11  
 检测标准 / Inspection & Testing: MSS SP-110, EN 12266

No.	PARTS NAME	MATERIAL		
1	阀体/Body	CF8M	CF8	WCB
2	螺母/Nut	SUS304		
3	阀盖/Cap	CF8M	CF8	WCB
4	球体/Ball	CF8M	CF8	
5	阀座/Seat	PTFE	RPTFE	
6	止推垫片/Thrust Washer	PTFE		
7	密封圈/Cap Gasket	PTFE		
8	弹簧垫圈/Spring Washer	SUS304		
9	填料/Stem Packing	PTFE		
10	填料压盖/Nut Gland	SUS304		
11	弹簧垫圈/Spring Washer	SUS304		
12	螺母/Nut	SUS304		
13	阀杆/Stem	SUS316	SUS304	
14	锁片/Locking Device	SUS301		
15	手柄/Handle	SUS304		
16	手柄套/Handle Cover	Plastic		
17	双头螺栓/Bolt	SUS304		

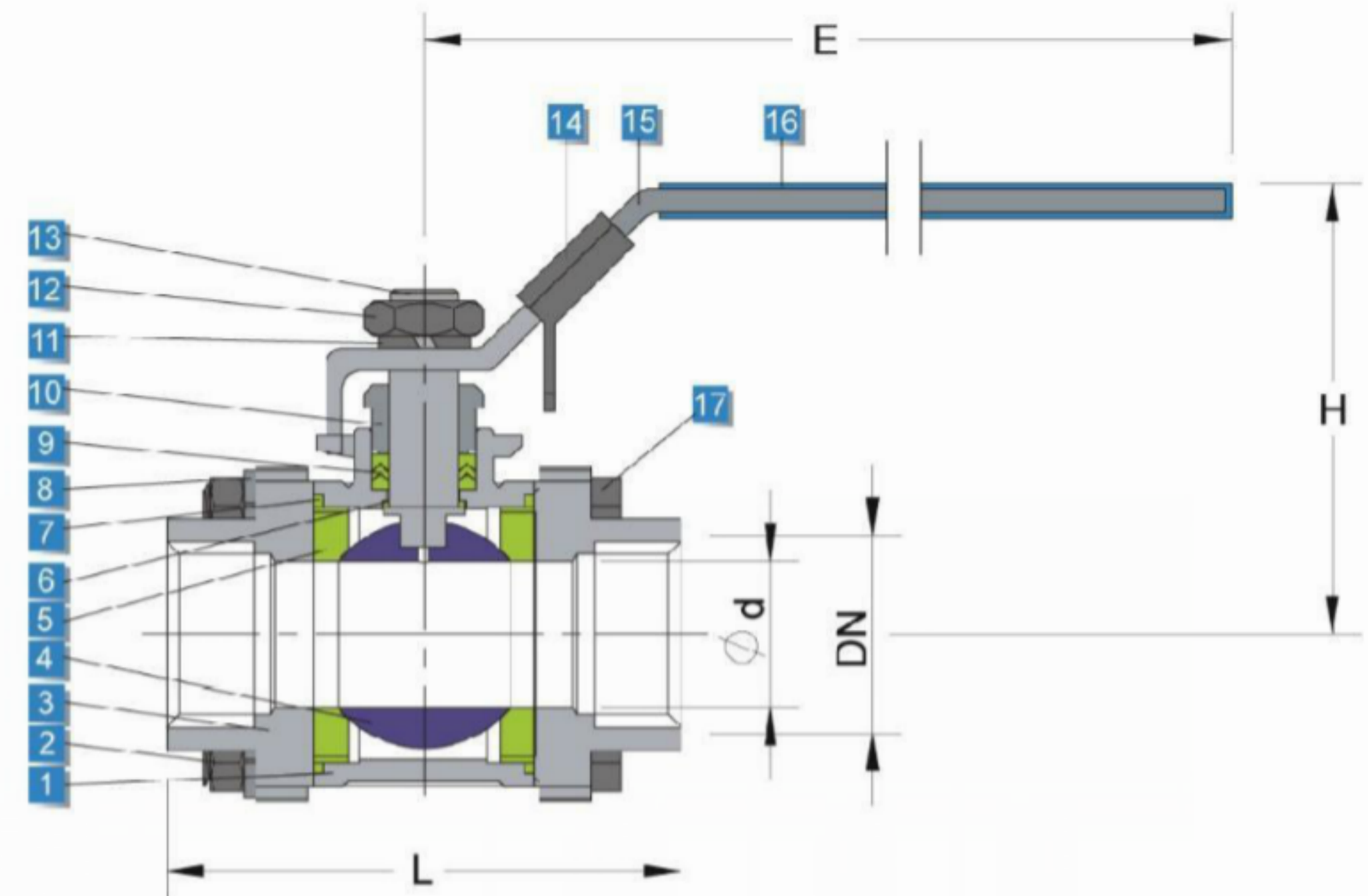
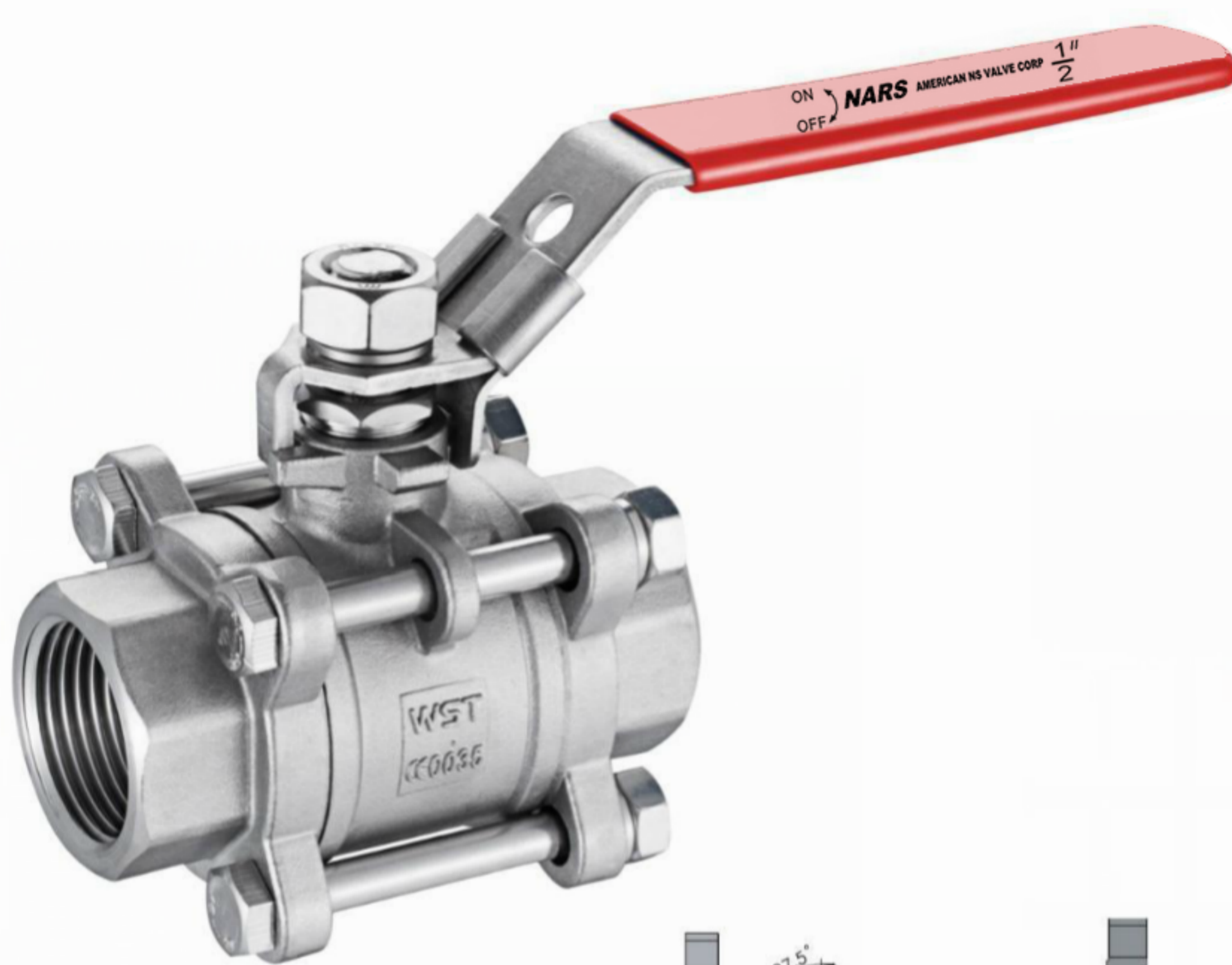

Butt Welding End

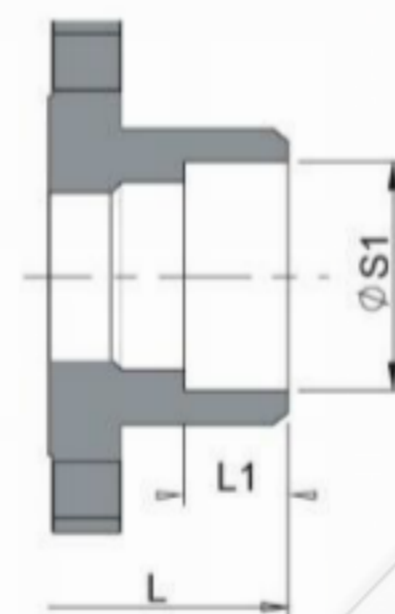

Socket End

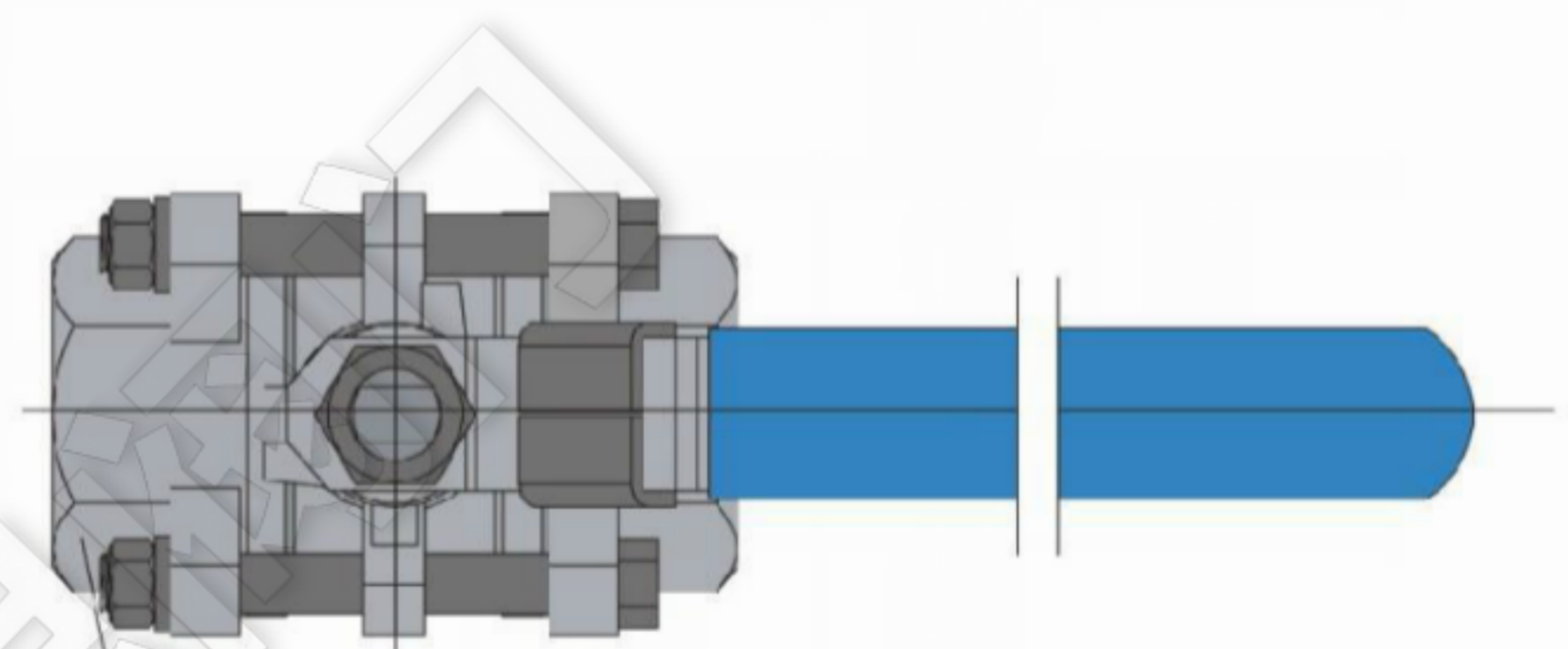

HEX.B

Unit:mm

DN	L	Ød	H	E	L1	ØS1	LB	ØB1	ØB2	HEX.B	THREAD
1/2"	60	15	59	98	10	21.8	60	15	22	25	NPT BSP PT DIN BSPT etc.
3/4"	70	20	67	120	13	27.3	70	20	26	30.5	
1"	80	24	70	120	13	34	80	24	34	39	
1-1/4"	92	31.5	80.5	150	16	42.8	92	31.5	42	47	
1-1/2"	107	38	94	170	16	48.9	107	38	47	54	
2"	125	48	102	170	17	61.4	125	48	60	66.5	
2-1/2"	160	64	125	250	17	74	160	64	75	81.5	
3"	180	76	135.5	250	17	90	180	76	90	97	
4"	225	98	165.5	300	20	115.4	225	98	110	124	



# NARSF001

1PC内螺纹球阀  
1PC Ball Valve 1000WOG

Threaded Ball Valves

## 产品特点 / FEATURES:

阀杆带有防脱出装置设计 Blow-out Proof Stem  
减流量 Reduced Port  
钢球球槽上有泄压孔设计 Pressure Balance Hole In Ball Slot  
多种螺纹端供选择 Various Thread Standards Available  
可选择挂锁装置 Lock Device

## 标准 / STANDARDS:

设计标准 / Design: ASME B16.34  
壁厚标准 / Wall Thickness: ASME B16.34  
螺纹标准 / Pipe Thread: ASME B1.20.1, BS21  
DIN 2999/259, ISO 228/1  
JIS B 0203, ISO 7/1  
检测标准 / Inspection & Testing: MSS SP-110, EN 12266

No.	PARTS NAME	MATERIAL		
1	阀体/Body	CF8M	CF8	WCB
2	阀杆/Stem	SUS316	SUS304	
3	弹簧垫圈/Spring Washer	SUS304		
4	止推垫片/Thrust Washer	PTFE		
5	填料压盖/Packing Gland	PTFE		
6	填料压套/Washer	PTFE		
7	球体/Ball	CF8M	CF8	
8	阀座/Seat	PTFE		
9	端塞(堵头)/End Plug	CF8M	CF8	WCB
10	手柄套/Handle Cover	Plastic		
11	锁片/Locking Device	SUS301		
12	手柄/Handle	Plastic		
13	螺母/Nut	SUS301		

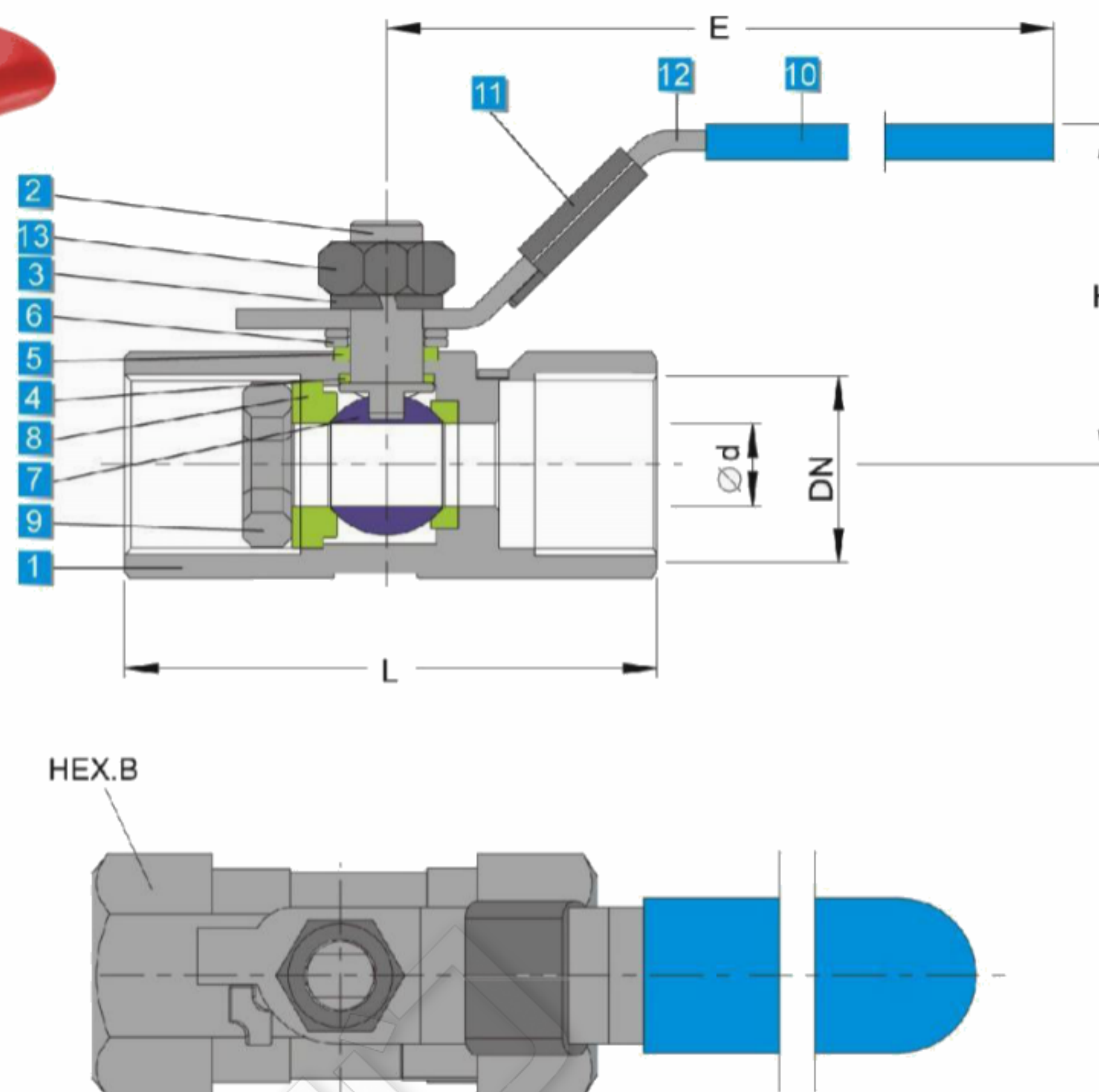
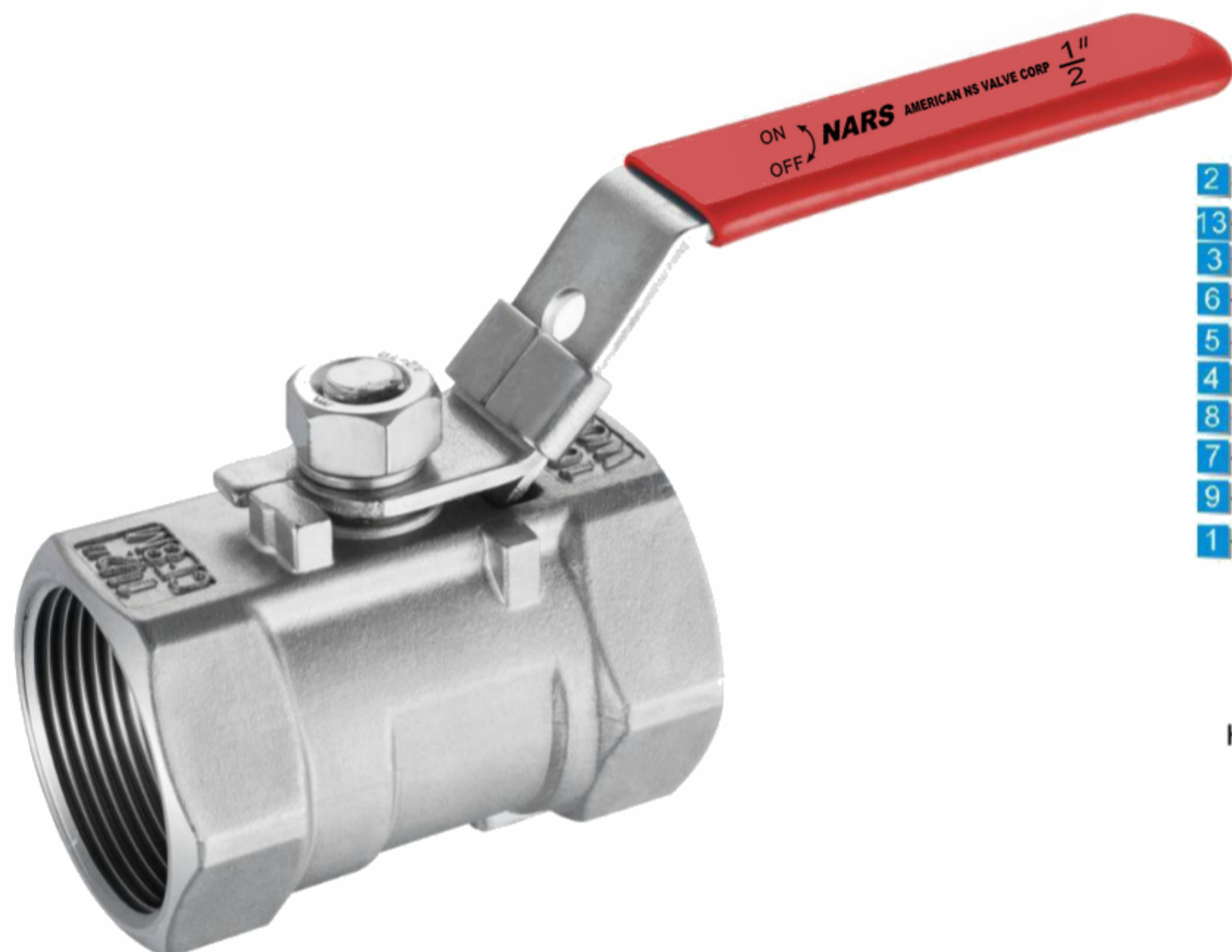

Unit:mm

DN	$\varnothing d$	L	H	E	HEX.B	End Thread
1/4"	5	39	31	70	17	NPT, MPT, BSPT, BSP, DIN, PT, etc.
3/8"	7	44	36	80	21	
1/2"	9	59	42	95	25	
3/4"	12.5	60	45	95	32	
1"	15	72	54	110	38	
1-1/4"	20	77	59	110	48	
1-1/2"	25	84	63.5	150	53	
2"	32	100	70	150	66	
2-1/2"	38	120	95	200	82	
3"	48	142	103	200	96	



**产品特点 / FEATURES:**

阀杆带有防脱出装置设计 Blow-out Proof Stem  
钢球球槽上有泄压孔设计  
Pressure Balance Hole in Ball Slot  
多种螺纹端供选择 Various Thread Standards Available  
可选择挂锁装置 Lock device

**标准 / STANDARDS:**

设计标准 / Design: ASME B16.34  
壁厚标准 / Wall Thickness: ASME B16.34  
螺纹标准 / Pipe Thread: ASME B1.20.1, BS21  
DIN 2999/259, ISO 228/1  
JIS B 0203, ISO 7/1  
检测标准 / Inspection & Testing: MSS SP-110, EN 12266

No.	PARTS NAME	MATERIAL		
1	阀体/Body	CF8M	CF8	WCB
2	垫片/Body Gasket		PTFE	
3	阀盖/Cap	CF8M	CF8	WCB
4	阀座/Seat	PTFE	RPTFE	PPL
5	球体/Ball	CF8M	CF8	
6	阀杆/Stem	SUS316	SUS304	
7	止推垫片/Thrust Washer		PTFE	
8	填料/Stem Packing	PTFE	RPTFE	
9	填料压盖/Packing gland		SUS304	
10	弹簧垫圈/Spring Washer		SUS304	
11	阀杆螺母/Stem Nut		A193-B8	
12	锁片/Locking Device		SUS301	
13	手柄/Handle		SUS304	
14	手柄套/Handle Cover		Plastic	

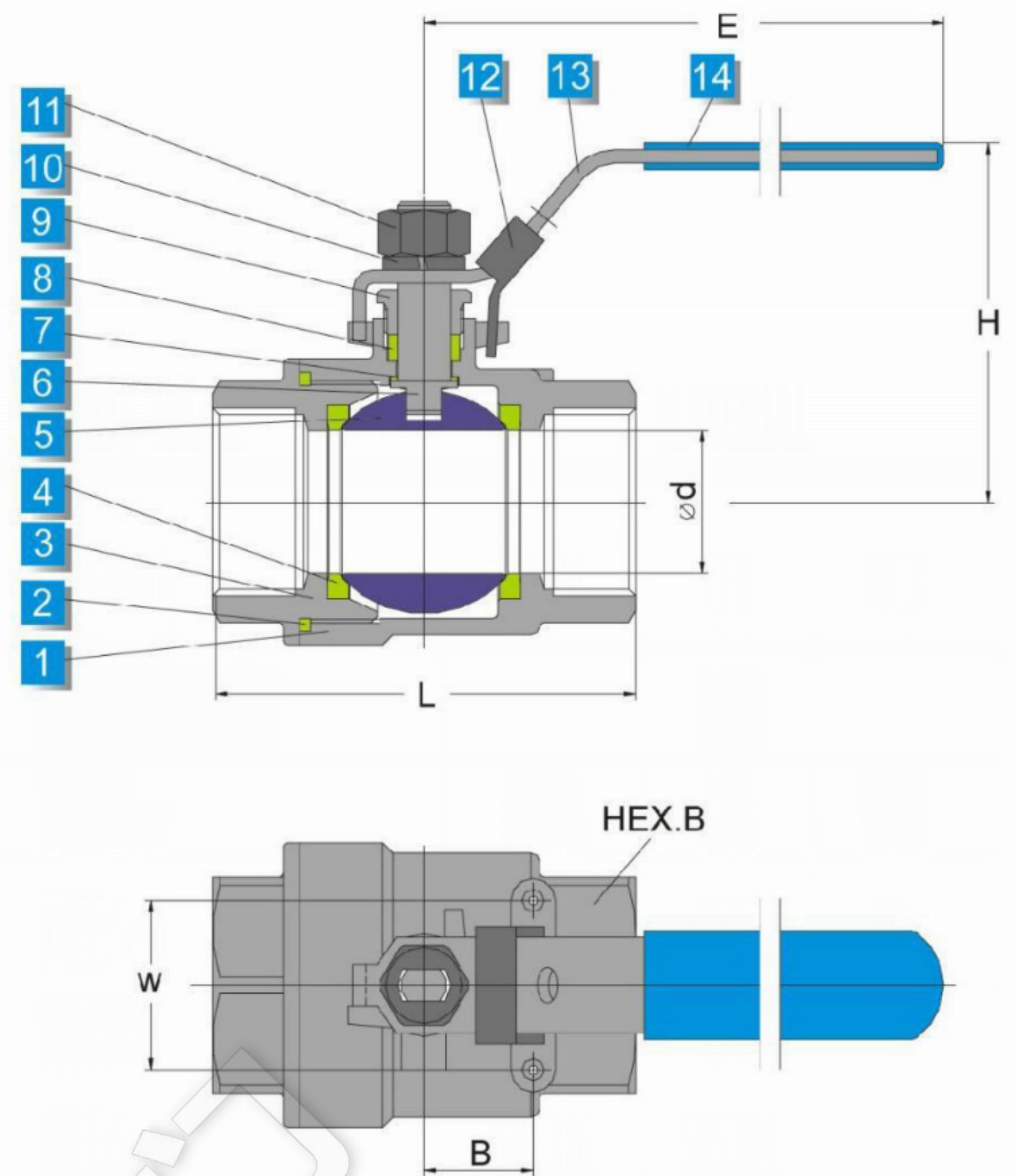
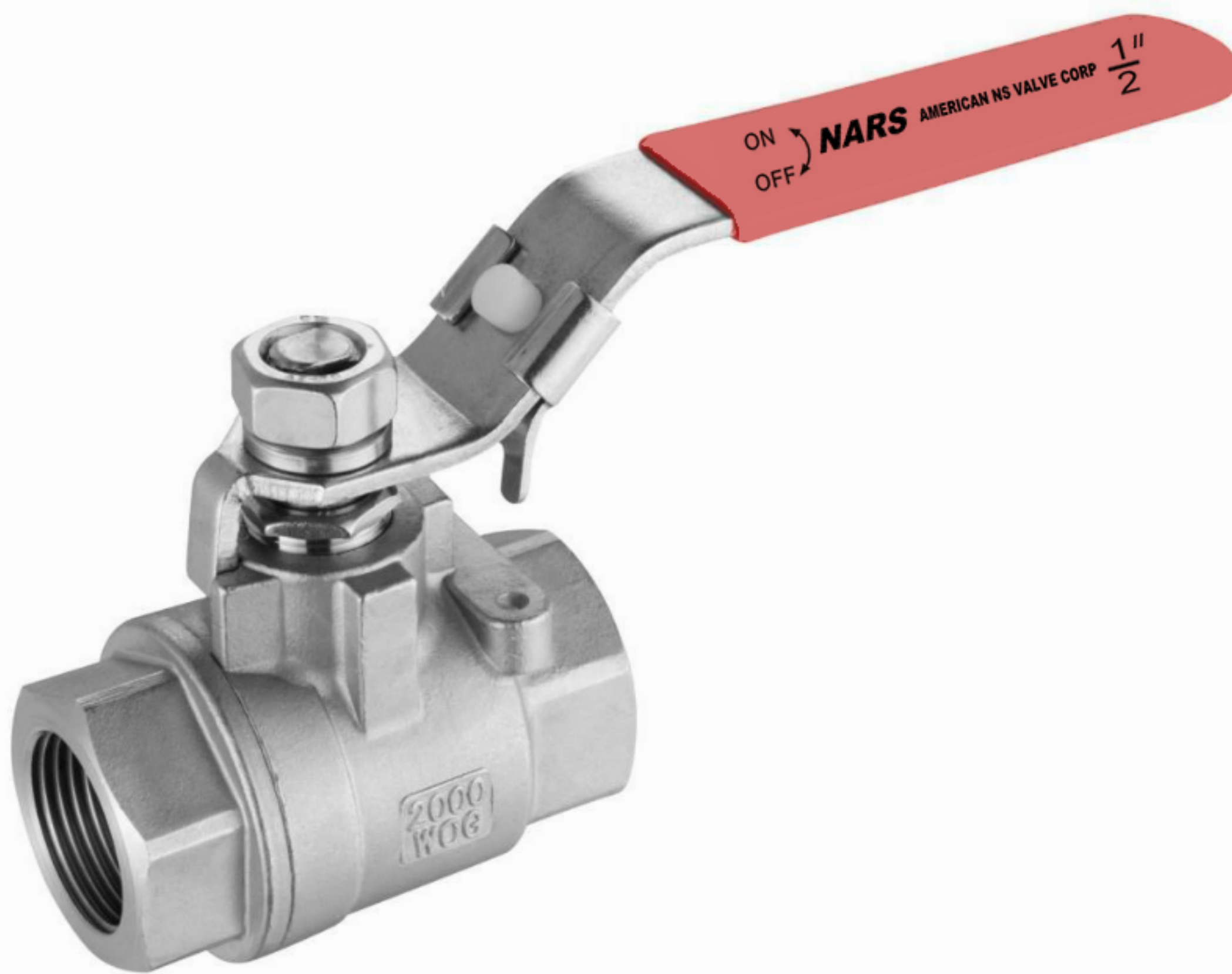

Unit:mm

Size	L	Ød	H	E	W	B	Thread
1/4"	55	10.5	56	100	29	21	NPT、MPT、BSPT、 BSP、DIN、PT、etc.
3/8"	55	10.5	56	100	29	25	
1/2"	63	15	65.5	120	29	31	
3/4"	74.5	20	72	150	33	36.5	
1"	87.5	25	81	170	33	43	
1-1/4"	102	32	88	170	38	52	
1-1/2"	107	38	97	190	38	60	
2"	124	48	121	190	38	72	